

REVOLVING WARNING LIGHT

WPD204

IP66



Describing

- Colours: Red, Orange.
- Dome: Polycarbonate resin with superior resistance to impact and heat.
- Body: Corrosion-resistant aluminum alloy casting with pass-through metal fixture.
- Operating temperature range: -30 °C ~ +80 °C
- Water-proof construction(IP66).
- Vibration Resistance: 10~55HZ Frequency, 0.5mm amplitude in Y direction for 40 minutes.
- Shock resistance 500m/s² acceleration(approx.50G)in Y direction for three times.

Dimensions

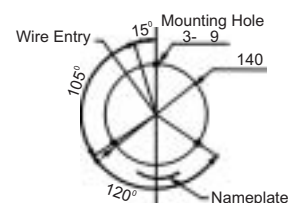
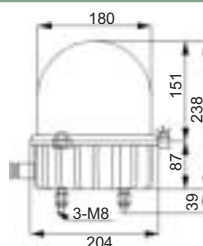

Type

Model	Rated Voltage	Bulb	Flashing Per Minute	Weight
WPD204-BB0B-R0	DC 12V	12V 35W	160f.p.m	3.0kg
WPD204-BB0E-R0	DC 24V	24V 35W		
WPD204-BB0M-R0	AC110V	120V 40W	140f.p.m	3.2kg
WPD204-BB0N-R0	A220V	220V 30W		

EPD224

IP54



Describing

- Colours: Red, Orange, Green, Blue.
- Dome: Drip-proof and dust-proof(meets 2G4) double structure of hard clear glass and acrylic resin.
- Body: Corrosion-resistant cast aluminum alloy with melamine baked coating on beautiful substrate using the gravity method.
- Low price, light-weight, compact design.
- Explosion-proof with a guard on the outer edge of the dome.
- Bulb can be easily replaced by unscrewing the dome frame.
- Parabolic reflector emits powerful rotary flash.
- Vibration Resistance: 10~55HZ Frequency, 0.5mm amplitude in Y direction for 40 minutes.
- Shock resistance 500m/s² acceleration(approx.50G)in Y direction for three times.

Dimensions

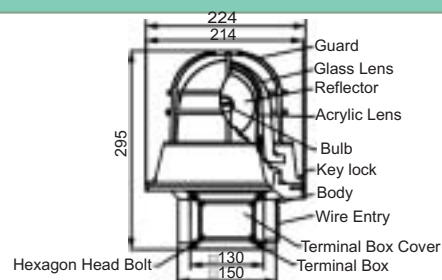
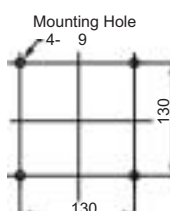

Type

Model	Rated Voltage	Bulb	Flashing Per Minute	Weight
EPD224-BB0B-R0	DC 12V	12V 10W	170f.p.m	6.5kg
EPD224-BB0E-R0	DC 24V	24V 10W		
EPD224-BB0G-R0	DC 48V	48V 10W		
EPD224-BB0M-R0	AC110V	12V 5W	170~180f.p.m	
EPD224-BB0N-R0	AC220V	12V 5W	160~170f.p.m	