

Q6、Q6.5、Q14

PART C-1 ~ C-55

Diameter	
● Shielded ○ non-Shielded	
Switching Distance Sn mm	
Housing Material	
● With LED ○ Without LED	

Dimensions (unit: mm)

Operating Voltage
Ripple
No Load Current
Max. Load Current
Leakge Current
Surge Current
Min. Load Current
Voltage Drop
Switching Frequency
Response Time
Switching Hysteresis
Repeat Accuracy
Protection Category
Operating Temperature
Temperature Drift
Short Circuit Protection
Overload Trip Point
Time Delay Before Availability
EMC
Shock / Vibration
Material Active Face

DC 3 wire 10-30V NPN N.O.
DC 3 wire 10-30V NPN N.C.
DC 3 wire 10-30V PNP N.O.
DC 3 wire 10-30V PNP N.C.
DC 4 wire 10-30V Changeover PNP (N.O. & N.C.)
DC 4 wire 10-30V Changeover NPN (N.O. & N.C.)
DC 2 wire 10-60V N.O.
DC 2 wire 10-60V N.C.
DC 3 wire 10-55v NPN N.O. or NAMUR
DC 3 wire 10-55v NPN N.C.
DC 3 wire 10-55v PNP N.O.
DC 3 wire 10-55v PNP N.C.
AC 2 wire 20-250V N.O.
AC 2 wire 20-250V N.C.
AC 20-250V N.O. or N.C. Changeable
AC/DC 2 wire 20-250V N.O.
AC/DC 2 wire 20-250V N.C.
AC/DC 20-250V N.O. or N.C. Changeable

Remark

Cable 2M (PVC)
Weight

DC INDUCTIVE PROXIMITY SWITCH SQUARE TYPE

Q 6
●
1.5 mm
PBT RESIN
●

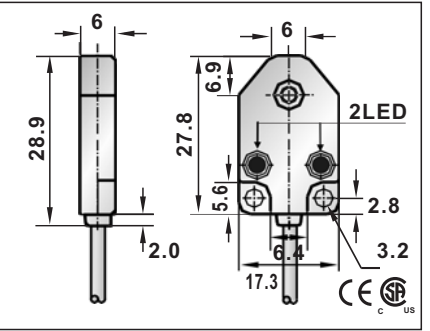

10-30VDC
<10%
<10mA
200mA
<0.01mA
-
-
<1.5V
500HZ
0.5ms/0.5ms
<15%(Sr)
<1.0%(Sr)
IP67
-25 °C - +70 °C
<10%(Sr)
YES
220mA
<10ms
RFI>3V/m / EFT>1KV / ESD>4KV (contact)
IEC 60947-5-2, Part 7.4.1 / IEC 60947-5-2, Part 7.4.2
PBT

Remark

Cable 2M (PVC)
Weight

Q 6.5
● ○
1.5 mm 2 mm
PBT RESIN
●

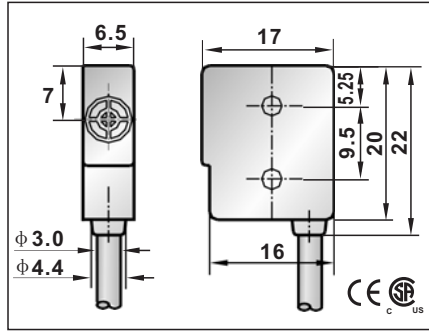

10-30VDC
<10%
<10mA
200mA
<0.01mA
-
-
<1.5V
500HZ
0.5ms/0.5ms
<15%(Sr)
<1.0%(Sr)
IP67
-25 °C - +70 °C
<10%(Sr)
YES
220mA
<10ms
RFI>3V/m / EFT>1KV / ESD>4KV (contact)
IEC 60947-5-2, Part 7.4.1 / IEC 60947-5-2, Part 7.4.2
PBT

Please see Page 18 for details and specifications of DC 2-Wire models on this page.

Cable 2M (PVC)
Weight

Q 14
●
10 mm
PBT RESIN
●

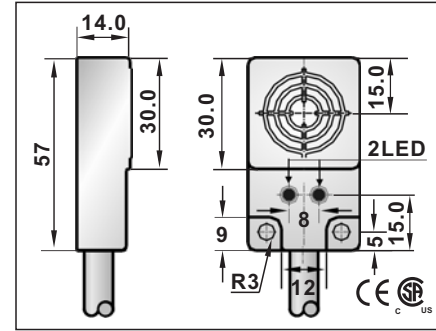

10-30VDC
<10%
<10mA
200mA
<0.01mA
-
-
<1.5V
500HZ
0.5ms/0.5ms
<15%(Sr)
<1.0%(Sr)
IP67
-25 °C - +70 °C
<10%(Sr)
YES
220mA
<10ms
RFI>3V/m / EFT>1KV / ESD>4KV (contact)
IEC 60947-5-2, Part 7.4.1 / IEC 60947-5-2, Part 7.4.2
PBT

FQP1-1410N-A3U2T	1
FQP1-1410N-B3U2T	2
FQP1-1410P-A3U2T	3
FQP1-1410P-B3U2T	4

Remark

Cable 2M (PVC)
Weight

Q16x28x10、Q16

DC INDUCTIVE PROXIMITY SWITCH SQUARE TYPE

DC INDUCTIVE PROXIMITY SWITCH SQUARE TYPE

Q16x28x10	
●	○
1 mm	2 mm
PBT RESIN	
●	

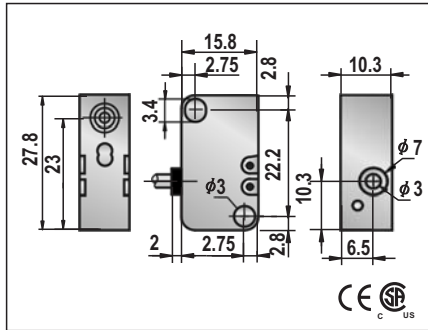

10-30VDC
<10%
<10mA
200mA
<0.01mA
-
-
<1.5V
2KHZ
0.1ms/0.1ms
<15%(Sr)
<1.0%(Sr)
IP67
-25 °C - +70 °C
<10%(Sr)
YES
220mA
<10ms
RFI>3V/m / EFT>1KV / ESD>4KV (contact)
IEC 60947-5-2,Part 7.4.1 / IEC 60947-5-2,Part 7.4.2

FQP1-Q2801N-A3U2X	1	FQP2-Q2802N-A3U2X
FQP1-Q2801N-B3U2X	2	FQP2-Q2802N-B3U2X
FQP1-Q2801P-A3U2X	3	FQP2-Q2802P-A3U2X
FQP1-Q2801P-B3U2X	4	FQP2-Q2802P-B3U2X
FQP1-Q2801C-A2U2X	7	FQP2-Q2802C-A2U2X
FQP1-Q2801C-B2U2X	8	FQP2-Q2802C-B2U2X

3 φ 3x0.15
Approx.55 g

Q16x28x10	
●	○
1 mm	2 mm
PBT RESIN	
●	

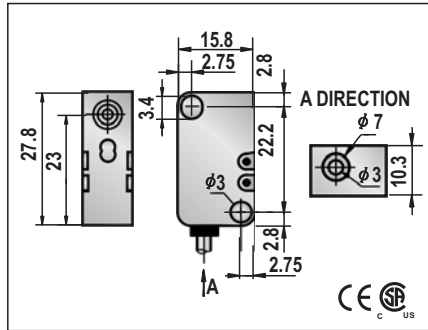

10-30VDC
<10%
<10mA
200mA
<0.01mA
-
-
<1.5V
2KHZ
0.1ms/0.1ms
<15%(Sr)
<1.0%(Sr)
IP67
-25 °C - +70 °C
<10%(Sr)
YES
220mA
<10ms
RFI>3V/m / EFT>1KV / ESD>4KV (contact)
IEC 60947-5-2,Part 7.4.1 / IEC 60947-5-2,Part 7.4.2

FQP1-2801N-A3U2	1	FQP2-2802N-A3U2
FQP1-2801N-B3U2	2	FQP2-2802N-B3U2
FQP1-2801P-A3U2	3	FQP2-2802P-A3U2
FQP1-2801P-B3U2	4	FQP2-2802P-B3U2
FQP1-2801C-A2U2	7	FQP2-2802C-A2U2
FQP1-2801C-B2U2	8	FQP2-2802C-B2U2

Please see Page 18 for details and specifications of DC 2-Wire models on this page.

3 φ 3x0.15
Approx.55 g

Q 16	
○	●
4 mm	
ABS RESIN	
●	

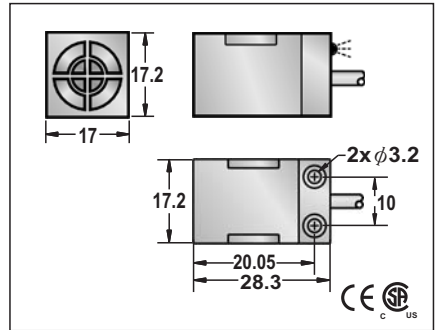

10-30VDC
<10%
<10mA
200mA
<0.01mA
-
-
<1.5V
500HZ
0.5ms/0.5ms
<15%(Sr)
<1.0%(Sr)
IP67
-25 °C - +70 °C
<10%(Sr)
YES
220mA
<10ms
RFI>3V/m / EFT>1KV / ESD>4KV (contact)
IEC 60947-5-2,Part 7.4.1 / IEC 60947-5-2,Part 7.4.2
POM

FQP2-1604N-A3U2	1
FQP2-1604N-B3U2	2
FQP2-1604P-A3U2	3
FQP2-1604P-B3U2	4
FQP2-1604C-A2U2	7
FQP2-1604C-B2U2	8

4 φ 3x0.15
Approx.55 g

Q18、Q18B、Q18C

DC INDUCTIVE PROXIMITY SWITCH SQUARE TYPE

DC INDUCTIVE PROXIMITY SWITCH SQUARE TYPE

Q 18
○
4 mm
ABS RESIN
●

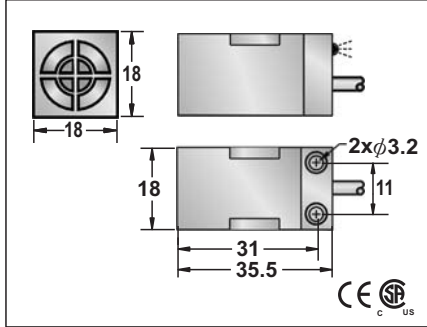

10-30VDC or 10-55VDC
<10%
<10mA or 20mA
200mA
<0.01mA
-
-
<1.5V or <2.0V
500HZ
0.5ms/0.5ms
<15%(Sr)
<1.0%(Sr)
IP67
-25 °C - +70 °C
<10%(Sr)
YES
220mA
<10ms
RFI>3V/m / EFT>1KV / ESD>4KV (contact)
IEC 60947-5-2,Part 7.4.1 / IEC 60947-5-2,Part 7.4.2
ABS

FQP2-1804N-A3U2	1
FQP2-1804N-B3U2	2
FQP2-1804P-A3U2	3
FQP2-1804P-B3U2	4

1. Voltage Drop:<1.5V(10-30V),<2V(10-55V).
2. 10-55V type: No Load Current < 20mA.
3. Please see Page 18 for details and specifications of DC 2-Wire models on this page.

4 φ 3x0.15
Approx.58 g

Q 18B
○
2 mm
POM RESIN
●

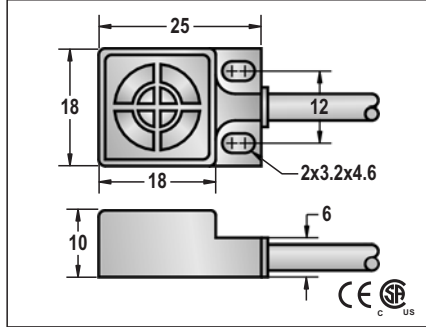

10-30VDC
<10%
<10mA
200mA
<0.01mA
-
-
<1.5V
500HZ
0.5ms/0.5ms
<15%(Sr)
<1.0%(Sr)
IP67
-25 °C - +70 °C
<10%(Sr)
YES
220mA
<10ms
RFI>3V/m / EFT>1KV / ESD>4KV (contact)
IEC 60947-5-2,Part 7.4.1 / IEC 60947-5-2,Part 7.4.2
POM

FQP2-18B02N-A3U2T	1	FQP2-18B02N-A3U2F
FQP2-18B02N-B3U2T	2	FQP2-18B02N-B3U2F
FQP2-18B02P-A3U2T	3	FQP2-18B02P-A3U2F
FQP2-18B02P-B3U2T	4	FQP2-18B02P-B3U2F

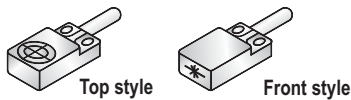

4 φ 3x0.15
Approx.46 g

Q 18C
●
4 mm
POM RESIN
●

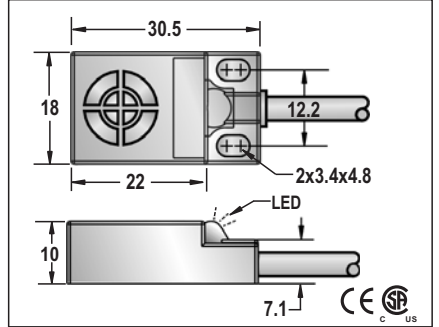

10-30VDC or 10-55VDC
<10%
<10mA or <20mA
200mA
<0.01mA
-
-
<1.5V or 2.0V
500HZ
0.5ms/0.5ms
<15%(Sr)
<1.0%(Sr)
IP67
-25 °C - +70 °C
<10%(Sr)
YES
220mA
<10ms
RFI>3V/m / EFT>1KV / ESD>4KV (contact)
IEC 60947-5-2,Part 7.4.1 / IEC 60947-5-2,Part 7.4.2
POM

FQP2-18C04N-A3U2T	1
FQP2-18C04N-B3U2T	2
FQP2-18C04P-A3U2T	3
FQP2-18C04P-B3U2T	4



4 φ 3x0.15
Approx.51 g

DC INDUCTIVE PROXIMITY SWITCH SQUARE TYPE

Q 42
●
20 mm
PBT RESIN
●

Q25s
●
10 mm
PBT RESIN
●

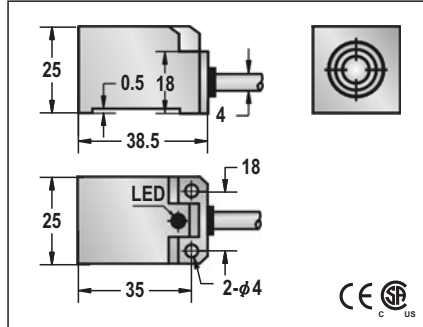
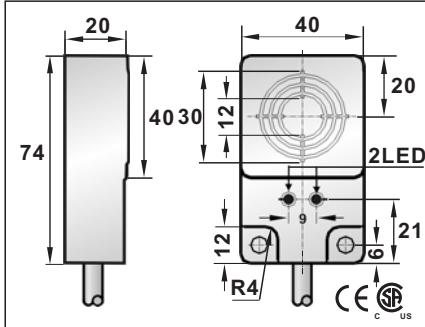

10-30VDC
<10%
<10mA
200mA
<0.01mA
-
<1.5V
500HZ
0.5ms/0.5ms
<15%(Sr)
<1.0%(Sr)
IP67
-25 °C - +70 °C
<10%(Sr)
YES
220mA
<10ms
RFI>3V/m / EFT>1KV / ESD>4KV (contact)
IEC 60947-5-2,Part 7.4.1 / IEC 60947-5-2,Part 7.4.2
PBT

10-30VDC or 10-55VDC
<10%
<10mA or <20mA
200mA
<0.01mA
-
<1.5V or 2.0V
300HZ
0.5ms/0.5ms
<15%(Sr)
<1.0%(Sr)
IP67
-25 °C - +70 °C
<10%(Sr)
YES
220mA
<10ms
RFI>3V/m / EFT>1KV / ESD>4KV (contact)
IEC 60947-5-2,Part 7.4.1 / IEC 60947-5-2,Part 7.4.2
-

FQP1-2020N-A3U2T	1
FQP1-2020N-B3U2T	2
FQP1-2020P-A3U2T	3
FQP1-2020P-B3U2T	4

FQP1-2510N-A3S2F	1
FQP1-2510N-B3S2F	2
FQP1-2510P-A3S2F	3
FQP1-2510P-B3S2F	4
FQP1-2510C-A2S2F	7
FQP1-2510C-B2S2F	8
HQP1-2510N-A3S2F	1
HQP1-2510N-B3S2F	2
HQP1-2510P-A3S2F	3
HQP1-2510P-B3S2F	4

Please see Page 18 for details and specifications of DC 2-Wire models on this page.

4φ 3x0.15
Approx.130 g

1. Voltage Drop:<1.5V(10-30V),<2V(10-55V).
2. 10-55V type: No Load Current < 20mA.
4φ 3x0.34
Approx.110 g

DC INDUCTIVE PROXIMITY SWITCH SQUARE TYPE

Q25s
●
10 mm
PBT RESIN
●

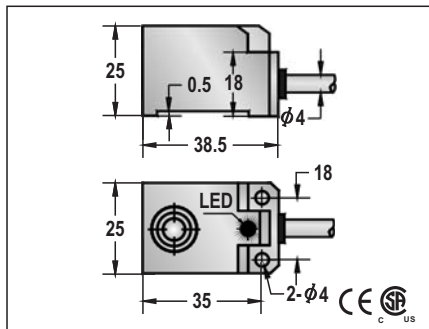

10-30VDC or 10-55VDC
<10%
<10mA or <20mA
200mA
<0.01mA
-
<1.5V or <2.0V
300HZ
0.5ms/0.5ms
<15%(Sr)
<1.0%(Sr)
IP67
-25°C - +75°C
<10%(Sr)
YES
220mA
<10ms
RFI>3V/m / EFT>1KV / ESD>4KV (contact)
IEC 60947-5-2,Part 7.4.1 / IEC 60947-5-2,Part 7.4.2
PBT

FQP1-2510N-A3S2T	1
FQP1-2510N-B3S2T	2
FQP1-2510P-A3S2T	3
FQP1-2510P-B3S2T	4
FQP1-2510C-A2S2T	7
FQP1-2510C-B2S2T	8

1. Voltage Drop:<1.5V(10-30V),<2V(10-55V).
 2. 10-55V type: No Load Current <20mA.

4 φ3x0.34
Approx.110 g

Q25
●
10 mm
PBT RESIN
●

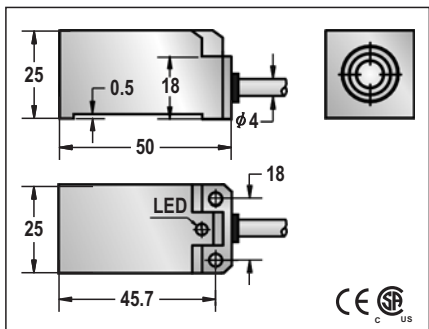

10-30VDC or 10-55VDC
<10%
<10mA or <20mA
200mA
<0.01mA
-
<1.5V or <2.0V
300HZ
0.5ms/0.5ms
<15%(Sr)
<1.0%(Sr)
IP67
-25°C - +70°C
<10%(Sr)
YES
220mA
<10ms
RFI>3V/m / EFT>1KV / ESD>4KV (contact)
IEC 60947-5-2,Part 7.4.1 / IEC 60947-5-2,Part 7.4.2
PBT

FQP1-2510N-A3U2F	1
FQP1-2510N-B3U2F	2
FQP1-2510P-A3U2F	3
FQP1-2510P-B3U2F	4
FQP1-2510C-A2U2F	7
FQP1-2510C-B2U2F	8

Please see Page 18 for details and specifications of DC 2-Wire models on this page.

4 φ3x0.34
Approx.110 g

Q25
●
10 mm
PBT RESIN
●

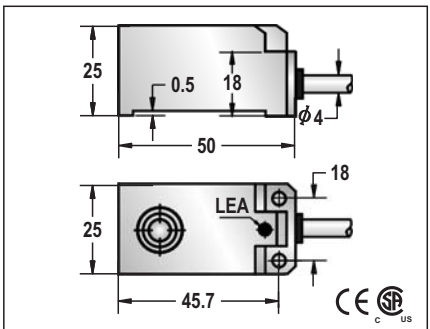

10-30VDC or 10-55VDC
<10%
<10mA or <20mA
200mA
<0.01mA
-
<1.5V or <2.0V
300HZ
0.5ms/0.5ms
<15%(Sr)
<1.0%(Sr)
IP67
-25°C - +75°C
<10%(Sr)
YES
220mA
<10ms
RFI>3V/m / EFT>1KV / ESD>4KV (contact)
IEC 60947-5-2,Part 7.4.1 / IEC 60947-5-2,Part 7.4.2
PBT

FQP1-2510N-A3U2T	1
FQP1-2510N-B3U2T	2
FQP1-2510P-A3U2T	3
FQP1-2510P-B3U2T	4
FQP1-2510C-A2U2T	7

4 φ3x0.34
Approx.120 g

Q30、Q40

DC INDUCTIVE PROXIMITY SWITCH SQUARE TYPE

Q30	
●	○
10 mm	15 mm
PBT RESIN	
●	

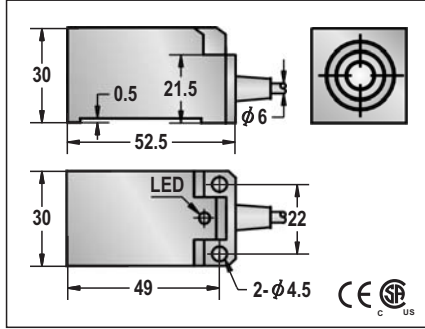

10-30VDC or 10-55VDC
<10%
<10mA or <20mA
200mA
<0.01mA
-
<1.5V or <2.0V
100HZ
1ms/1ms
<15%(Sr)
<1.0%(Sr)
IP67
-25 °C - +70 °C
<10%(Sr)
YES
220mA
<10ms
RFI>3V/m / EFT>1KV / ESD>4KV (contact)
IEC 60947-5-2,Part 7.4.1 / IEC 60947-5-2,Part 7.4.2
PBT

FQP1-3010N-A3U2F	1	FQP2-3015N-A3U2F
FQP1-3010N-B3U2F	2	FQP2-3015N-B3U2F
FQP1-3010P-A3U2F	3	FQP2-3015P-A3U2F
FQP1-3010P-B3U2F	4	FQP2-3015P-B3U2F

1.Voltage Drop:<1.5V(10-30V),<2V(10-55V).
2. 10-55V type: No Load Current < 20mA.

5.8φ 3x0.5
Approx.155 g

Q30	
●	○
10 mm	15 mm
PBT RESIN	
●	

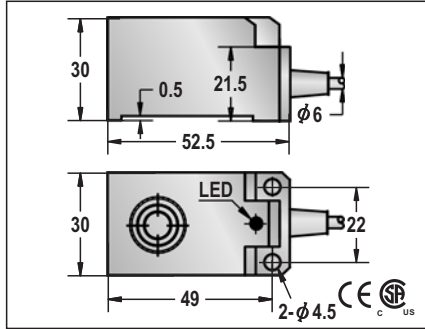

10-30VDC or 10-55VDC
<10%
<10mA or <20mA
200mA
<0.01mA
-
<1.5V or <2.0V
100HZ
1ms/1ms
<15%(Sr)
<1.0%(Sr)
IP67
-25 °C - +75 °C
<10%(Sr)
YES
220mA
<10ms
RFI>3V/m / EFT>1KV / ESD>4KV (contact)
IEC 60947-5-2,Part 7.4.1 / IEC 60947-5-2,Part 7.4.2
PBT

FQP1-3010N-A3U2T	1	FQP2-3015N-A3U2T
FQP1-3010N-B3U2T	2	FQP2-3015N-B3U2T
FQP1-3010P-A3U2T	3	FQP2-3015P-A3U2T
FQP1-3010P-B3U2T	4	FQP2-3015P-B3U2T

Please see Page 18 for details and specifications of DC 2-Wire models on this page.

5.8φ 3x0.5
Approx.155 g

Q40	
●	○
15 mm	30 mm
PBT RESIN	
●	

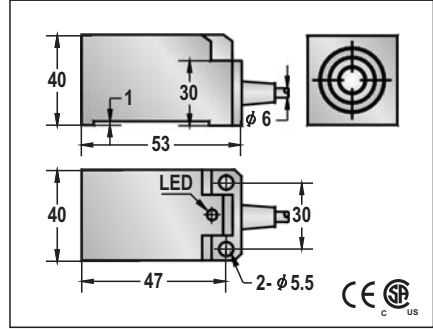

10-30VDC or 10-55VDC
<10%
<10mA or <20mA
200mA
<0.01mA
-
<1.5V or <2.0V
100HZ
1ms/1ms
<15%(Sr)
<1.0%(Sr)
IP67
-25 °C - +70 °C
<10%(Sr)
YES
220mA
<10ms
RFI>3V/m / EFT>1KV / ESD>4KV (contact)
IEC 60947-5-2,Part 7.4.1 / IEC 60947-5-2,Part 7.4.2
PBT

FQP1-4515N-A3U2F	1	FQP2-4530N-A3U2F
FQP1-4515N-B3U2F	2	FQP2-4530N-B3U2F
FQP1-4515P-A3U2F	3	FQP2-4530P-A3U2F
FQP1-4515P-B3U2F	4	FQP2-4530P-B3U2F

5.8φ 3x0.5
Approx.190 g

Q40、Q25x40x12、Q30x45x12

DC INDUCTIVE PROXIMITY SWITCH SQUARE TYPE

DC INDUCTIVE PROXIMITY SWITCH SQUARE TYPE

Q40	
●	○
15 mm	30 mm
PBT RESIN	
●	

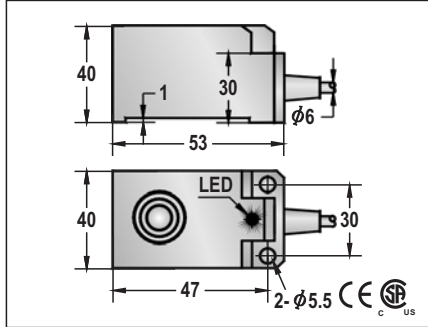

10-30VDC or 10-55VDC	
<10%	
<10mA	or <20mA
200mA	
<0.01mA	
-	
-	
<1.5V	or <2.0V
100HZ	
1ms/1ms	
<15%(Sr)	
<1.0%(Sr)	
IP67	
-25 °C - +70 °C	
<10%(Sr)	
YES	
220mA	
<10ms	
RFI>3V/m / EFT>1KV / ESD>4KV (contact)	
IEC 60947-5-2,Part 7.4.1 / IEC 60947-5-2,Part 7.4.2	
PBT	

FQP1-4515N-A3U2T	1	FQP2-4530N-A3U2T
FQP1-4515N-B3U2T	2	FQP2-4530N-B3U2T
FQP1-4515P-A3U2T	3	FQP2-4530P-A3U2T
FQP1-4515P-B3U2T	4	FQP2-4530P-B3U2T

1. Voltage Drop:<1.5V(10-30V),<2V(10-55V).
 2. 10-55V type: No Load Current < 20mA.

5.8 φ 3x0.5
Approx.190 g

Q25x40x12	
●	○
2 mm	4 mm
PBT RESIN	
●	

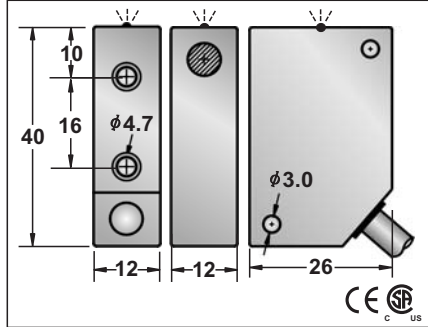

10-30VDC or 10-55VDC	
<10%	
<10mA	or <20mA
200mA	
<0.01mA	
-	
-	
<1.5V	or <2.0V
300HZ	
0.5ms/0.5ms	100HZ
1ms/1ms	
<15%(Sr)	
<1.0%(Sr)	
IP67	
-25 °C - +70 °C	
<10%(Sr)	
YES	
220mA	
<10ms	
RFI>3V/m / EFT>1KV / ESD>4KV (contact)	
IEC 60947-5-2,Part 7.4.1 / IEC 60947-5-2,Part 7.4.2	
PBT	

FQP1-4002N-A3U2	1	FQP2-4004N-A3U2
FQP1-4002N-B3U2	2	FQP2-4004N-B3U2
FQP1-4002P-A3U2	3	FQP2-4004P-A3U2
FQP1-4002P-B3U2	4	FQP2-4004P-B3U2
FQP1-4002P-S4U2	6	FQP2-4004P-S4U2
FQP1-4002N-S4U2	5	FQP2-4004N-S4U2
FQP1-4002C-A2U2	7	FQP2-4004C-A2U2
FQP1-4002C-B2U2	8	FQP2-4004C-B2U2

Please see Page 18 for details and specifications of DC 2-Wire models on this page.

4.0 φ 3x0.15
Approx.133 g

Q30x45x12	
●	○
10 mm	15 mm
PBT RESIN	
●	

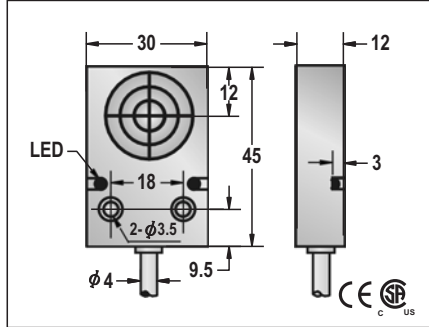

10-30VDC or 10-55VDC	
<10%	
<10mA	or <20mA
200mA	
<0.01mA	
-	
-	
<1.5V	or <2.0V
100HZ	
1ms/1ms	
<15%(Sr)	
<1.0%(Sr)	
IP67	
-25 °C - +70 °C	
<10%(Sr)	
YES	
220mA	
<10ms	
RFI>3V/m / EFT>1KV / ESD>4KV (contact)	
IEC 60947-5-2,Part 7.4.1 / IEC 60947-5-2,Part 7.4.2	
PBT	

FQP1-3110N-A3U2T	1	FQP2-3115N-A3U2T
FQP1-3110N-B3U2T	2	FQP2-3115N-B3U2T
FQP1-3110P-A3U2T	3	FQP2-3115P-A3U2T
FQP1-3110P-B3U2T	4	FQP2-3115P-B3U2T

4 φ 3x0.34
Approx.100 g

